

FOOTREST FLIP-UP

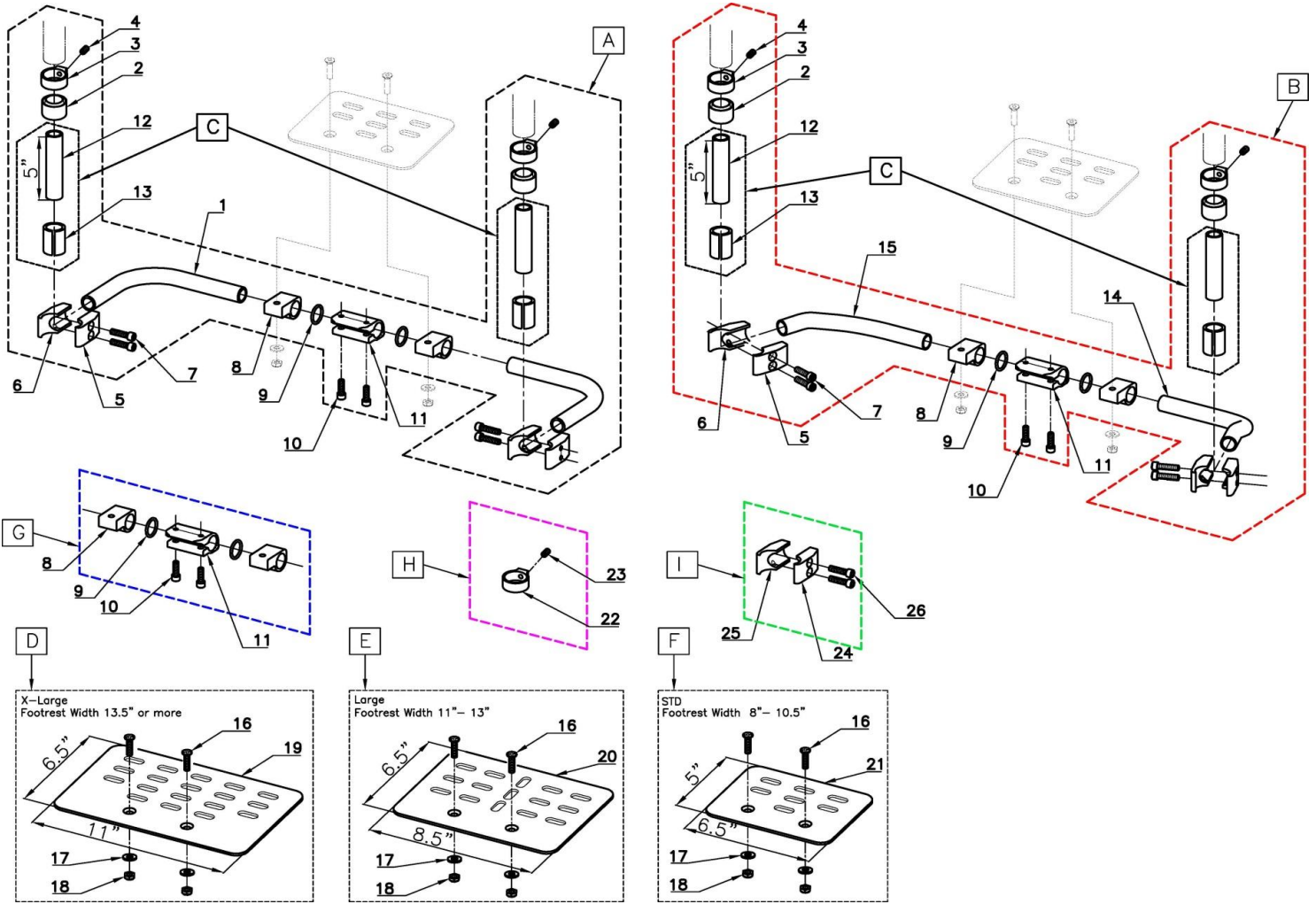

POS	Assy #	#	Parts #	QTY	Color	Remark	MSRP	NOTE
A	2300-01A	1		2	Blk	Need Footrest Width	\$250/set	1set/chair
		2	0082-300	2	Blk	Plastic Slip Fit Bushing-		
		3	0168-301	2	Blk	Footrest Ring		
		4	0256-301	2	Sil	1/4"-28 L:1/2" SS		
		5	0472-105	2	Blk	Inner Clamp		
		6	0472-110	2	Blk	Outer Clamp		
		7	0110-300	4	Sil	1/4"-20 L:1" SHCS		
		8	0472-125	2	Blk	Flipback Footrest Mount		
		9	0472-302	2	Blk	O-Ring		
		10	0501-300	2	Sil	1/4"-20 L:3/4" SHCS		
		11	0472-121	1	Blk	Flipback Footrest Clamp		
		12	0416-080	2	Blk	Flipback Extension Tube		
		13	0472-115	2	Blk	Flipback Footrest Reducer		
B	2300-01B	14		1	Blk	Need Footrest Width (L)	\$250/set	1set/chair
		15		1	Blk	Need Footrest Width (R)		
		2	0082-300	2	Blk	Plastic Slip Fit Bushing-		
		3	0168-301	2	Blk	Footrest Ring		
		4	0256-301	2	Sil	1/4"-28 L:1/2" SS		
		5	0472-105	2	Blk	Inner Clamp		
		6	0472-110	2	Blk	Outer Clamp		
		7	0110-300	4	Sil	1/4"-20 L:1" SHCS		
		8	0472-125	2	Blk	Flipback Footrest Mount		
		9	0472-302	2	Blk	O-Ring		
		10	0501-300	2	Sil	1/4"-20 L:3/4" SHCS		
		11	0472-120	1	Blk	Center Joint Clamp		
		12	0416-080	2	Blk	Flipback Extension Tube		
13	0472-115	2	Blk	Flipback Footrest Reducer				

POS	Assy #	#	Parts #	QTY	Color	Remark	MSRP	Note
C	2300-01C	12	0416-080	2	Blk	Flipback Extension Tube	\$35/set	1set/chair
		13	0472-115	2	Blk	Flipback Footrest Reducer		
D	2300-01D	16	0437-300	2	Sil	1/4"-20 L:1" FHPS	\$60/set	1set/chair
		17	0116-300	2	Sil	1/4" Washer		
		18	0277-300	2	Sil	1/4"-20 Nylon HLN		
		19	0416-302	1	Blk	X-Large		
E	2300-01E	16	0437-300	2	Sil	1/4"-20 L:1" FHPS	\$60/set	1set/chair
		17	0116-300	2	Sil	1/4" Washer		
		18	0277-300	2	Sil	1/4"-20 Nylon HLN		
		20	0416-301	1	Blk	Large		
F	2300-01F	16	0437-300	2	Sil	1/4"-20 L:1" FHPS	\$60/set	1set/chair
		17	0116-300	2	Sil	1/4" Washer		
		18	0277-300	2	Sil	1/4"-20 Nylon HLN		
		21	0416-300	1	Blk	STD		
G	2300-01G	8	0472-125	2	Blk	Flipback Footrest Mount	\$60/set	1set/chair
		9	0472-302	2	Blk	O-Ring		
		10	0501-300	2	Sil	1/4"-20 L:3/4" SHCS		
H	2200-01H	22	0168-301	1	Blk	Footrest Ring	\$20/set	2set/chair
I	2300-01I	23	0256-301	1	Blk	1/4"-28 L:1/2" SS	\$30/set	2set/chair
		24	0472-105	1	Blk	Inner Clamp		
		25	0472-110	1	Blk	Outer Clamp		
		26	0110-300	2	Sil	1/4"-20 L:1" SHCS		