

FOOTREST

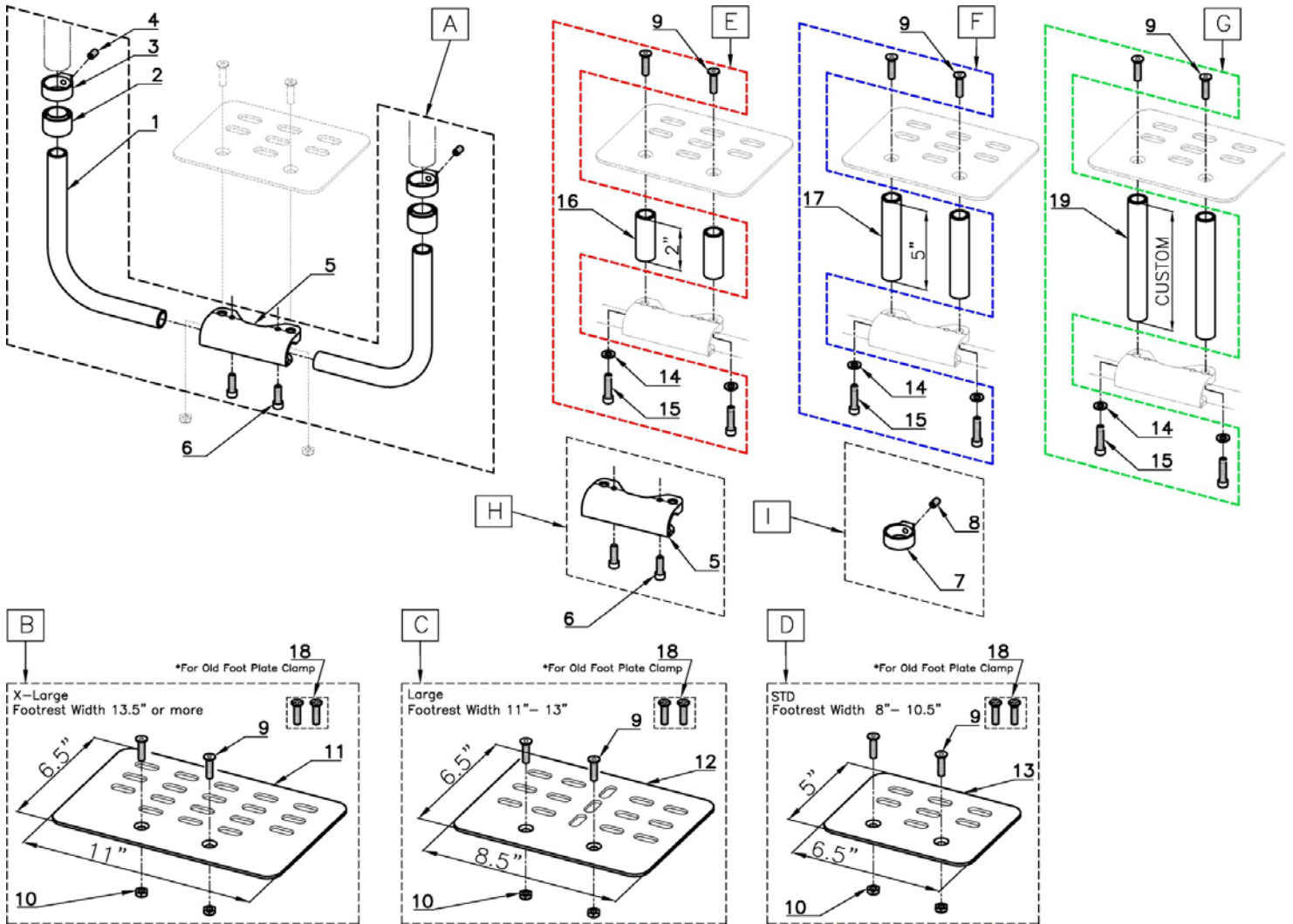

POS	Assy #	#	Parts #	QTY	Color	Remark	MSRP	NOTE
A	2200-01A	1	0416-198	2	Blk	For Footrest Width 8"-9.5"	\$110/set	1set/chair
			0416-199	2	Blk	For Footrest Width 10"-11.5"		
			0416-200	2	Blk	For Footrest Width 12"-13.5"		
			0416-201	2	Sil	For Footrest Width 14"-15.5"		
			0416-202	2	Blk	For Footrest Width 16"-17.5"		
			0416-203	2	Blk	For Footrest Width 18"-19.5"		
B	2200-01B	2	0082-300	2	Blk	Plastic Slip Fit Bushing	\$60/set	1set/chair
			0168-301	2	Blk	Footrest Ring		
			0256-301	2	Sil	1/4"-28 L:1/2" SS		
			0416-304	1	Blk	Foot Plate Clamp		
C	2200-01C	2	0501-300	2	Sil	1/4"-20 L:3/4" SHCS	\$60/set	1set/chair
			0541-314	2	Blk	1/4"-20 L:3/4 SFHCS		
			0116-300	2	Sil	1/4"-20 Nylon HLN		
D	2200-01D	2	0116-300	2	Sil	1/4"-20 Nylon HLN	\$60/set	1set/chair
			0416-120	1	Blk	X-Large		
			0437-300	2	Sil	1/4"-20 L:1" FHPS		
E	2200-01E	2	0541-314	2	Blk	1/4"-20 L:3/4 SFHCS	\$60/set	1set/chair
			0116-300	2	Sil	1/4"-20 Nylon HLN		
			0416-113	1	Blk	Large		
F	2200-01F	2	0437-300	2	Sil	1/4"-20 L:1" FHPS	\$60/set	1set/chair
			0416-112	1	Blk	STD		
			0416-305	1	Blk	2" Riser		
G	2200-01G	2	0541-314	2	Blk	1/4"-20 L:3/4 SFHCS	\$60/set	1set/chair
			0277-300	2	Sil	1/4" W		
			0110-300	2	Sil	1/4"-20 L:1" SHCS		
H	2200-01H	2	0416-310	1	Blk	5" Riser	\$60/set	1set/chair
			0541-314	2	Blk	1/4"-20 L:3/4 SFHCS		
			0277-300	2	Sil	1/4" W		
I	2200-01I	2	0110-300	2	Sil	1/4"-20 L:1" SHCS	\$60/set	1set/chair
			0416-310	1	Blk	5" Riser		
			-	1	Blk	Custom Length Riser		

POS	Assy #	#	Parts #	QTY	Color	Remark	MSRP	Note
D	2200-01D	2	0541-314	2	Blk	1/4"-20 L:3/4 SFHCS	\$60/set	1set/chair
			0116-300	2	Sil	1/4"-20 Nylon HLN		
			0416-112	1	Blk	STD		
E	2200-01E	2	0437-300	2	Sil	1/4"-20 L:1" FHPS	\$30/set	1set/chair
			0541-314	2	Blk	1/4"-20 L:3/4 SFHCS		
			0277-300	2	Sil	1/4" W		
F	2200-01F	2	0110-300	2	Sil	1/4"-20 L:1" SHCS	\$30/set	1set/chair
			0416-305	1	Blk	2" Riser		
			0541-314	2	Blk	1/4"-20 L:3/4 SFHCS		
G	2200-01G	2	0277-300	2	Sil	1/4" W	\$40/set	1set/chair
			0110-300	2	Sil	1/4"-20 L:1" SHCS		
			0110-300	2	Sil	1/4"-20 L:1" SHCS		
H	2200-01H	2	0416-304	1	Blk	Foot Plate Clamp	\$28/set	1set/chair
			0501-300	2	Sil	1/4"-20 L:3/4" SHCS		
			0168-301	1	Blk	Footrest Ring		
I	2200-01I	2	0256-301	1	Sil	1/4"-28 L:1/2" SS	\$20/set	2set/chair
			0168-301	1	Blk	Footrest Ring		