

CASTER FORK w / Suspension Spring

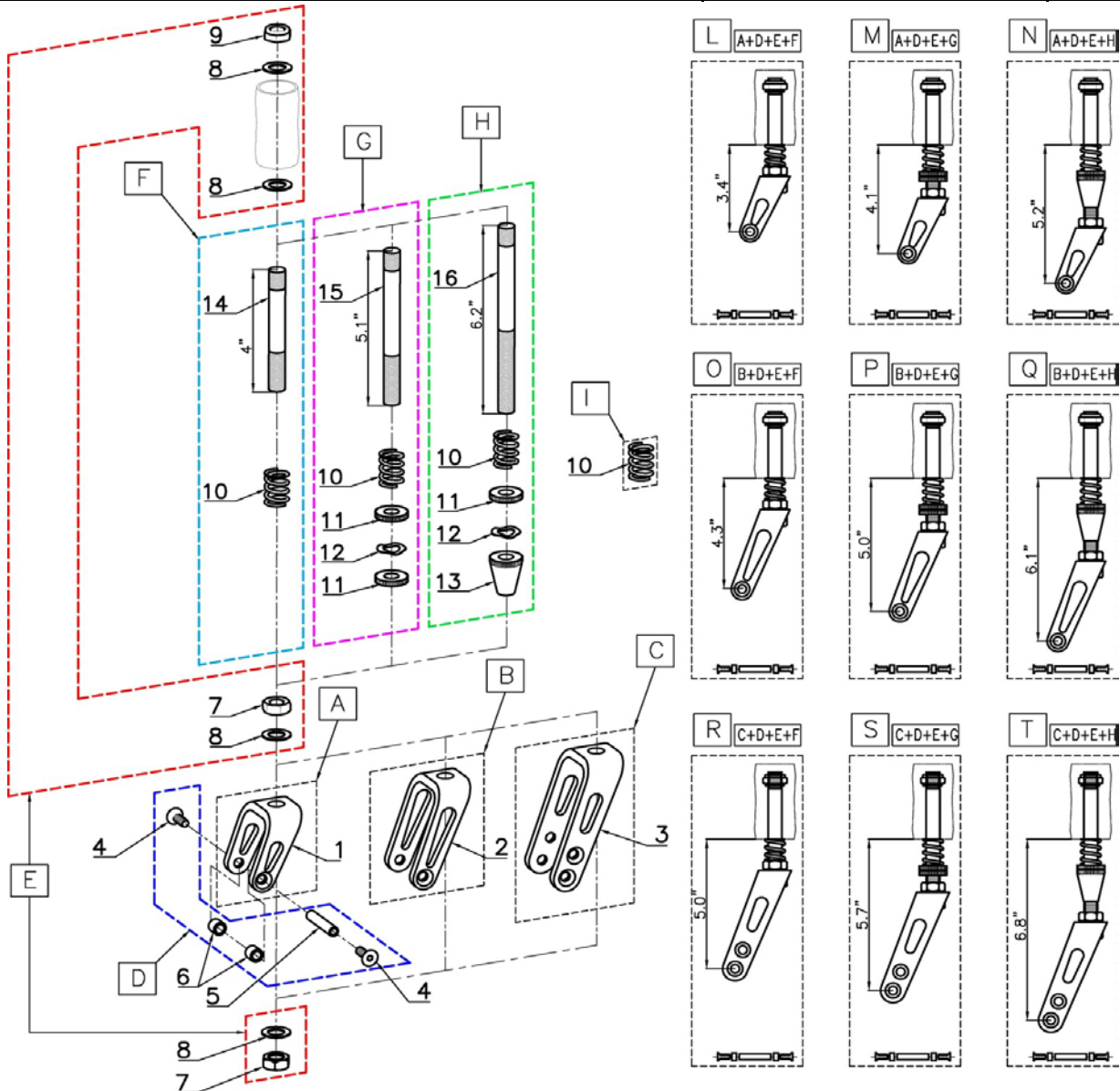

POS	Assy #	#	Parts #	QTY	Color	Remark	MSRP	NOTE
A	-	1	0307-300	1	Blk	Short	\$30/1pcs	2pcs/chair
B	-	2	0307-301	1	Blk	Med	\$30/1pcs	2pcs/chair
C	-	3	0307-303	1	Blk	Long	\$32/1pcs	2pcs/chair
D	1400-01D	4	0620-400	2	Sil	1/4"-28 L:3/4 SFHCS	\$10/set	2sets/chair
		5	0605-300	1	Sil	Front Caster Axle		
		6	0257-300	2	Sil	3/8" L:1/4" Spacer		
E	1400-01E	7	0121-300	2	Sil	1/2" -20 Nut	\$10/set	2sets/chair
		8	0119-300	4	Sil	1/2" thin Washer		
		9	0260-300	1	Sil	1/2"-20 Nylon HLN		
F	1500-01F	10	0176-300	1	Sil	Suspension Spring	\$45/set	2sets/chair
		14	0408-310	1	Sil	Short Axle for Spring		
G	1500-01G	10	0176-300	1	Sil	Suspension Spring	\$55/set	2sets/chair
		11	0122-300	2	Blk	Knurl Nut - Small		
		12	0120-300	1	Sil	1/2" thin Wavy Wwasher		
H	1500-01H	15	0408-311	1	Blk	Med Axle for Spring	\$60/set	2sets/chair
		10	0176-300	1	Sil	Suspension Spring		
		11	0122-300	1	Blk	Knurl Nut - Small		
		12	0120-300	1	Sil	1/2" thin Wavy Wwasher		
I	-	13	0123-300	1	Blk	Knurl Nut - Large	\$25/1pcs	2pcs/chair
		16	0408-304	1	Blk	Long Axle for Spring		

POS	Assy #	#	Parts #	QTY	Color	Remark	MSRP	Note
L	1500-01L	-	-	1set	-	Short Fork & Short Axle	\$90/set	2sets/chair
M	1500-01M	-	-	1set	-	Short Fork & Med Axle	\$95/set	2sets/chair
N	1500-01N	-	-	1set	-	Short Fork & Long Axle	\$100/set	2sets/chair
O	1500-01O	-	-	1set	-	Med Fork & Short Axle	\$90/set	2sets/chair
P	1500-01P	-	-	1set	-	Med Fork & Med Axle	\$95/set	2sets/chair
Q	1500-01Q	-	-	1set	-	Med Fork & Long Axle	\$100/set	2sets/chair
R	1500-01R	-	-	1set	-	Long Fork & Short Axle	\$90/set	2sets/chair
S	1500-01S	-	-	1set	-	Long Fork & Med Axle	\$95/set	2sets/chair
T	1500-01T	-	-	1set	-	Long Fork & Long Axle	\$100/set	2sets/chair